

CONTROL VALVES FOR CAMSHAFT ADJUSTMENT

11314

ENGINE 1.4 TFSI, 1.6 FSI



AUDI A1, A3, ŠKODA OCTAVIA, VW GOLF V, GOLF VI, PASSAT, POLO

Art.No.: **V10-3731**

X-Ref: 03C 906 455 A

ENGINE 1.0 - 1.4 TFSI

TO 2013



AUDI A1, A3, SEAT LEON, ŠKODA OCTAVIA, VW GOLF VII, POLO, UP

Art.No.: **V10-4333**

X-Ref: 04E 906 455

ENGINE 1.0 - 1.4 TFSI

FROM 2013



AUDI A1, A3, A4, ŠKODA OCTAVIA, VW GOLF VII, PASSAT

Art.No.: **V10-3926**

X-Ref: 04E 906 455 D

ENGINE 1.6 - 2.0i



BMW E46, E90, E60, E65, E63, E84, E83, E53, E70, E84

Art.No.: **V20-2760**

X-Ref: 11 36 7 560 462

ENGINE 1.6i

FROM 2012



BMW F20, F21, F30, F31

Art.No.: **V20-2761**

X-Ref: 11 36 8 610 388

ENGINE 1.6 - 1.8



OPEL ASTRA H + J, INSIGNIA, VECTRA C, MOKKA, SIGNUM, ZAFIRA B

Art.No.: **V40-1426**

X-Ref: 12 35 299

Notes: Temporary offers are only valid while stocks last. All offers remain subject to prior sale. Our general terms and conditions of sale and delivery as well as our warranty conditions apply, which are available for download on our website. All prices are net prices. Errors excepted. Reference numbers of vehicle manufacturers are non-binding and no indication of origin. They may not be disclosed in invoices. © VIEROL AG

EN VAICO_11314_Steuerventil-Nockenwellenverstellung-EU_20161117

CONTROL VALVE FOR CAMSHAFT ADJUSTMENT

11314

FUNCTION

The control valve is a proportional valve. Its four ports each form a connection to the oil pump, to the return and to the two working chambers of the camshaft adjuster. The inner control slider of the valve is displaced as soon as power is applied to the electromagnet so as to switch the oil pressure between the working chambers. The working chamber, which is in each case not being supplied with oil pressure, is connected to the return line. In order to fix the timing position, the valve is brought into the central position. In this position, the connections of all terminals are separated from each other.

The modular, yet very compactly designed valve allows various modifications to be adapted to the corresponding location of use. The connector can be modified in shape and position depending on the use case. The same applies for the type of compressed oil feed.

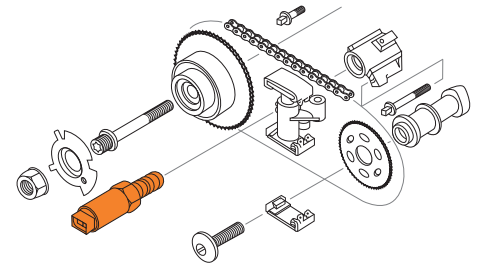

SYMPTOMS

- high fuel consumption
- power loss
- irregular engine running
- rattling noise from the timing chaine
- check engine light comes on, engine emergency



FAILURE CAUSES

- contamination of the oil chambers
- contact problems other electrical causes
- high thermal stress



CONSEQUENTIAL DAMAGES

- the chain skips with too little chain tension
- motor damage

CONTROL VALVES FOR CAM ADJUSTMENT OF VAICO

These and 200 articles in the field of control valves for camshaft adjustment can be found at www.autoteile.de

- ✓ largest range on the market
- ✓ many control valves/solenoids exclusive only available at VAICO
- ✓ 100% function check in the production process guarantees the best quality



Notes: Temporary offers are only valid while stocks last. All offers remain subject to prior sale. Our general terms and conditions of sale and delivery as well as our warranty conditions apply, which are available for download on our website. All prices are net prices. Errors excepted. Reference numbers of vehicle manufacturers are non-binding and no indication of origin. They may not be disclosed in invoices. © VIEROL AG